



# CITY OF SANTA BARBARA WATERFRONT DEPARTMENT

## EAST BEACH MOORING/ANCHORING PROGRAM

### Project Statistics

A.P.N. 017-191-0WF  
 Zone PR-SD-3  
 Latitude 34° 24.59  
 Longitude 119° 40.13

### Project Owner

City of Santa Barbara  
 Waterfront Department  
 PO Box 1990  
 Santa Barbara, CA 93102  
 (805) 564-5531

### Project Description

The East Beach Mooring/Anchoring Program is designed to provide 48 mooring spaces for individually permitted vessels, plus seasonal anchoring opportunities for non-permitted vessels. By formalizing the mooring area and enforcing ground-tackle specifications for moored vessels, the Waterfront Department hopes to decrease pollution, vessel groundings on East Beach and financial impacts to the City.

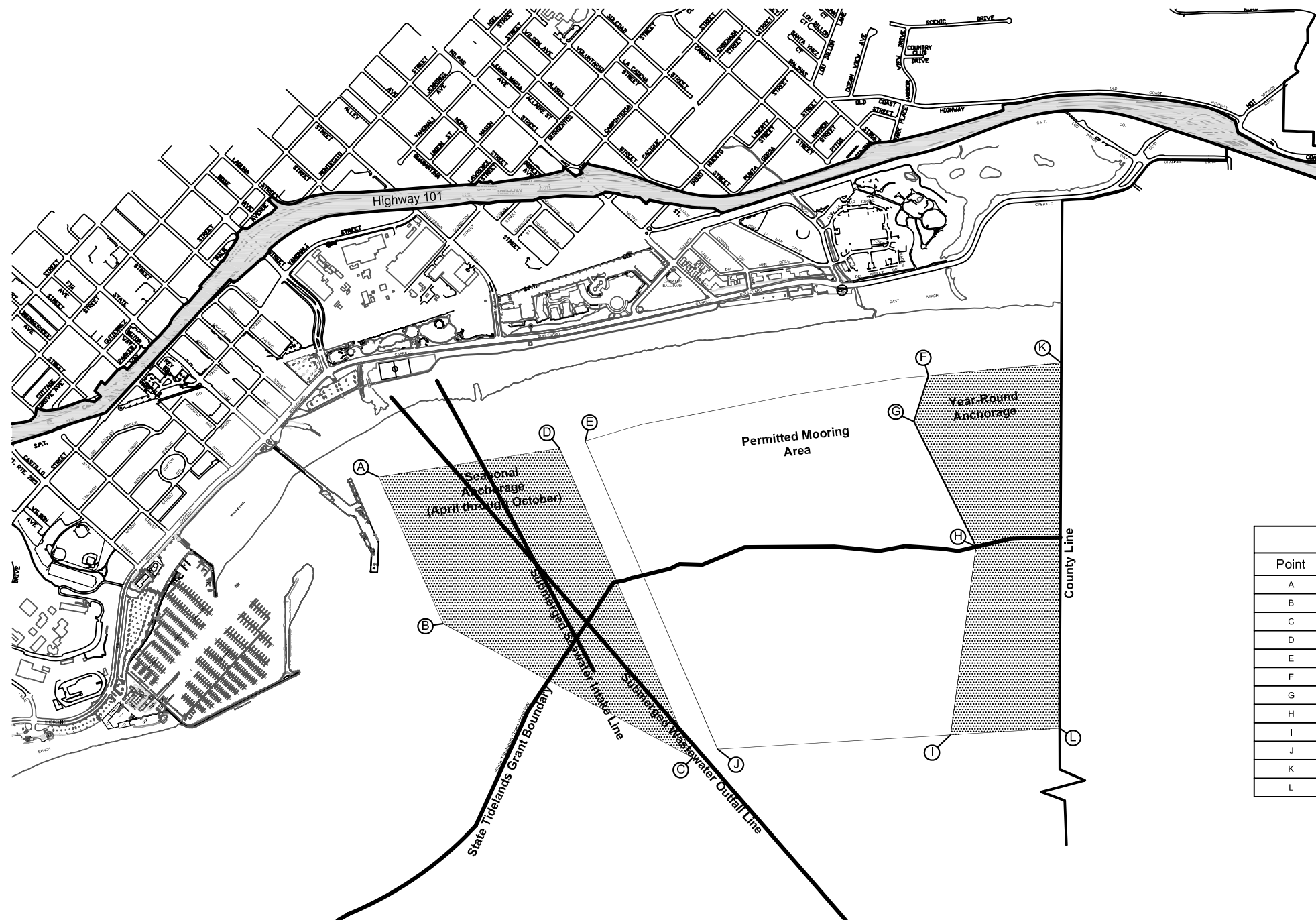

Project Boundaries		
Point	Latitude	Longitude
A	34° 24.6608'	119° 41.0896'
B	34° 24.3870'	119° 40.9384'
C	34° 24.1428'	119° 40.3668'
D	34° 24.7207'	119° 40.6802'
E	34° 24.7354'	119° 40.6227'
F	34° 24.8687'	119° 39.8462'
G	34° 24.7819'	119° 39.8769'
H	34° 24.5485'	119° 39.7307'
I	34° 24.1937'	119° 39.7819'
J	34° 24.1593'	119° 40.3102'
K	34° 24.8968'	119° 39.5443'
L	34° 24.2098'	119° 39.5346'

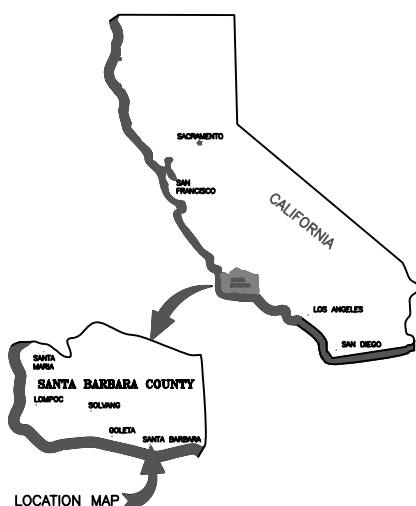

Vicinity Map  
 NTS

Project Location  
 Scale 1" = 700'

ADD OUTFALL & INTAKE LINES	1/20/05	LA	DRAFTER	L.Arroyo
FINALIZE MOORING/ANCHORING BOUNDARIES	2/14/06	MK	DRAFTER	J. J.
			DESIGNER	L.Arroyo
			CHECKER	
			PROJ. MNGR.	M.Kronman
			DRAWING DATE	7/16/04
DESCRIPTION	DATE	APPROVED		
REVISIONS				

East Beach Mooring/Anchoring Program  
 City of Santa Barbara  
 Waterfront Department

CITY OF SANTA BARBARA  
 WATERFRONT DEPARTMENT- FACILITIES DIVISION

SCALE: Noted  
 FACTOR: N/A  
 VERT. N/A  
 HOR. N/A

PROJ. NO. \_\_\_\_\_  
 SHT. 1 OF 2 SHTS.  
 DWG. NO. 6003-014