

• BOAT SHOW GUIDE •

NEW LOCATION FOR 2016!

Strictly Sail Pacific

April 7-10, 2016

Craneway Pavilion and
Marina Bay Yacht Harbor
Richmond, CA

THE WEST COAST'S ONLY

All-Sail BOAT SHOW!

Visit StrictlySailPacific.com for tickets and show details



Find us on:
facebook.



#SSPAC16



INSIDE:

- Seminars
- New Products
- Boat Showcase
- Show Highlights

PETTIT



HYDROCOAT^{eco}

COPPER-FREE ABLATIVE ANTIFOULING

- *The first copper-free, water-based ablative*
- *Dual biocides for multi-season protection*
- *Ablative technology eliminates sanding or paint build-up*
- *Easy cleanup with soap and water*



pettitpaint.com • 800-221-4466

AIR AND SEA WILL NEVER KNOW.

All you sceptics who believe you can't get real fouling protection without heavy loads of copper and solvent, meet the mind changer. Hydrocoat ECO. Water-based Hydrocoat ECO is a new clean world of solvent-free antifouling. It contains the breakthrough additive Econeal that reduces copper by 100% yet delivers 100% of the copper effectiveness. It's all about maximum protection with minimum impact. It's a clean new day.

HYDROCOAT^{eco}
Copper-Free Ablative Antifouling

Strictly Sail Pacific

April 7-10
Richmond, California

LOCATION

In the historic Craneway Pavilion and Marina Bay Yacht Harbor in Richmond, CA. See pages 36-37 for accommodations, transportation, directions and parking details. No pets are allowed in the show. Only guide dogs, signal dogs, or other animals individually trained to provide assistance to an individual with a disability are allowed.

SHOW HOURS

Thursday, April 7:	10 a.m. – 6 p.m.
Friday, April 8:	10 a.m. – 6 p.m.
Saturday, April 9:	10 a.m. – 6 p.m.
Sunday, April 10:	10 a.m. – 5 p.m.

ADMISSION

Thrifty Thursday Adult Ticket*	\$14
One-Day Adult Ticket	\$18
Two-Day Adult Ticket (online only)	\$28
Four-Day Pass (online only)	\$48
Children 12 and younger (must be accompanied by a paying adult)	Free

*Available online only through March 24.



 Join us on Facebook at www.facebook.com/StrictlySailPacific

 Follow us on Twitter at www.twitter.com/StrictlySailPac

CONTENTS

Ticket Information/Show Hours.....	4
Association Manager's Welcome	6
New Boat Showcase	8
Cool Products	12
Show Highlights.....	16
Advance Registration Seminars	22-25
Free Seminars	26
Let's Party	28
Exhibitor List	30-33
Accommodations	34
Local Contacts/Travel/Dining	35
Transit/Parking/Directions	36-37
Advertisers' Index.....	39

SKIP THE LINES – PURCHASE TICKETS ONLINE

Save time and money by purchasing your tickets online at www.strictlysailpacific.com.

Enter Promotional Code "SHOWGUIDE" and save \$2 on the ticket price.

IMPORTANT SHOW UPDATES:

All information in this directory is accurate at the time of printing. Sail America may, however, make changes and substitutions to the show layout, event programming, seminars and exhibitor listing, etc.

Please visit www.strictlysailpacific.com for the latest show news and updates.

Thank you to our sponsors





Jeanneau Yachts 54

Love is in the Air

The Jeanneau Yachts 54 is a luxury sailing yacht that sets a new standard for comfort and performance, with a remarkable level of innovation. Every attention has been given to each space and purpose. Her interior design by Andrew Winch is a brilliant rendition of form following function: elegance in action.



JEANNEAU
YACHTS

410.280.9400 info@jeanneau.com www.jeanneau.com
Jeanneau Yachts 54 57 64

Welcome to the 2016 Strictly Sail Pacific Boat Show – A Four-Day Sailing Extravaganza!

Welcome to the 21st Strictly Sail Pacific Boat Show at the Marina Bay Yacht Harbor and Craneway Pavilion – one of the planet's most iconic destinations. Set on 25 waterfront acres, the award-winning, architecturally significant Craneway Pavilion delivers an awe-inspiring panorama of the Bay, San Francisco skyline and surrounding environs.

Every April sailors from up and down the West Coast and around North America gather for the Strictly Sail Pacific Sailboat Show. This internationally-acclaimed sailboat show is the largest and oldest in-water sailboat show on the West Coast and hosts all that is hot in the world of sailing. We guarantee you'll enjoy the new show location and find everything you are looking for!

Show highlights include:

- More than 40,000 sq/ft of single floor exhibit hall space filled with sailing gear, hardware and accessories.
- New boat introductions and more boat brands in-the-water than ever before.
- Free shuttle services to ensure getting around the show is as enjoyable as easy.
- Discover Sailing – experience sailing for the first time or expand your sailing knowledge with one of our many hands-on on-the-water learning classes!
- SailSFBay.org exhibit where you can exchange your life jacket for a new one or drop in and speak with former Oakland Raider and sailor David Casper.
- Check out our variety of fine dining with our assortment of Bay Area food trucks.
- Free Cruisers Seminar Series – over ninety seminars on topics from sailing destinations to outfitting your boat! Learn from the experts on a host of topics, from cool new products that nobody knows about and long-distance family cruising, to weather and communications.
- Advanced Sailing Seminars – We have assembled some of the best speakers that will help you extend your learning to the next level. Sign up for the US Sailing Coastal Safety at Sea seminar, moderated by Chuck Hawley, that meets the new training requirements for sailors racing in San Francisco offshore races. Check out our other seminars, led by industry pros like Lee Chesneau and Jeff and Jean from Two Can Sail.
- Authors' Corner to find the latest nautical books and meet the sailors that have 'been there and done that'.
- Special Events – Join us for planned events. From Stand Up Paddleboard racing to remote-controlled sailboats races, Race 2 Alaska to racing with Copepods, and Belly Biology to Bob Bitchin – we have something for everyone!

One thing is for certain...if you're into sailing or have any interest in the sailing lifestyle, this is THE place to be April 7-10, 2016. Come with friends or bring the family!

I hope to see YOU there.

Good Sailing,



Peter Durant
Association Manager, Sail America



PETER DURANT

Official Show Guide



Produced by



21st Strictly Sail Pacific Boat Show

Association Manager

Peter Durant

Sales Manager

Sara Watson

Marketing Manager

Chelsey Barton Karnes

Operations Manager

Jorgen Bateman

Show Office Support

Stephanie Grove

Seminar Coordinator

Kate Stanley

Discover Sailing

Coordinator

Gary Edelman

Finance Manager

Kayce Florio

Show Guide Published by

Latitude 38



Stop by
and see the
latest J/Boats!



Come to Strictly Sail Pacific and step aboard the new J/97E, J/88 and J/70

J.
97_E

Pure sailing boat.
Fast, easy to sail,
and comfortable.

With a family crew, the J/97E can cruise anywhere with unparalleled ease in sumptuous accommodations. Underneath that exotic, sinfully luxurious interior is a pure thoroughbred – the unbridled, raw power of a Ferrari 12-cylinder engine rumbling to a roar to blast you around the track while you relax in Rolls Royce ultra-leather comfort and relish Jaguar-like silkiness in the S-turns – a rare combination indeed.

J.
88

The 29-ft Family Speedster with Stability, Style and Sailing Comfort

The J/88 hits the sweet spot in J/Boats' performance sprit range – large enough to provide the creature comforts of a sit-in cockpit, inboard diesel, overnighting interior and head; and small enough to be single-point lifted, and owner trailered and stored. The order backlog is building, so come have a look and order your J/88 today.

J.
70

The Hot, New NextGen Family Trailer Sailer

The J/70 Speedster (22.75 feet) is J/Boats' first ramp-launchable keelboat, designed to fulfill the growing need for an easy-to-own, high performance one design that is exciting to sail, stable enough for the family, and built to last. With fleets established around the world, the J/70 is on track to take the world by storm.

*Come by the show to see the newest in the J/Boat line-up.
We'll then make arrangements for the best part of any J/Boat –
the not-to-be missed test sail.*

Call San Francisco (510) 523-8500 • www.sailcal.com

New Boat Showcase

J/88

From the J design/build team that launched the J/70 and J/111 comes the NEW J/88, a 29-ft mid-size family speedster with stability, style and sailing comfort. The J/88 has met with critical acclaim in the boating press, awarded the 'Best Boat Under 30 Feet' in the 2014 *Sailing World* Boat of the Year competition.



JEANNEAU 54 –

Designed For the Way You Live

Every aspect of the Jeanneau 54 is all-new and designed to fit the way you live, like no other yacht in her class. Never-before-seen solutions are found throughout, from the clever VIP interior layout to the spacious living cockpit, and the easy and discreet management of the tender and innovative aft terrace.



HOBIE TANDEM ISLAND

Sailing has never seemed so simple. When the wind blows, the Tandem Island flies across the water, powered by an expansive, easily-tended mainsail. Hop aboard with a friend. With dual MirageDrives providing pedal power, maneuvering is a snap even when the zephyrs subside. See the Hobie Tandem Island plus the Bravo, Wave, kayaks and more.



LAGOON 450

Above decks you'll find a steering station on the fly bridge with safe access from both sides for perfect visibility, large sunbathing area, spacious cockpit on same level as the galley, a second cockpit making best use of the forward area, safe and effective transom platforms.

Below decks offers elegance and functionality with exceptionally well-lit saloon and cabins, truly luxurious owner's and guests' cabins, U-shaped galley for greater comfort at sea, and so much more.



CATALINA 445

The Catalina 445 incorporates crisp, contemporary styling with proportions and features that make Catalinas comfortable and secure underway, as well as on the hook. Based on a new hull design with a long waterline and moderate beam and freeboard, the 445 delivers excellent performance in a wide range of conditions. The hull form is optimized to provide the gentle, predictable motion underway, which is so appreciated in other Catalina models.



BENETEAU OCEANIS 41.1

The 41.1 establishes all new standards for mid-sized yachts by offering maximum seakeeping ability, comfort and customizable space at an even more competitive price. With her self-tacking jib and German sheet system, the 41.1 is a much easier boat to sail in any and all wind conditions. With the Finot Conq-designed chined hull, you have a modern testament to comfort at sea.





PASSAGE NAUTICAL ENTERPRISES

Point Richmond (510) 236-2633 / Oakland (510) 864-3000 / PassageNautical.com

INTRODUCING THE NEW
OCEANIS 41.1



TOUR THESE BENETEAU POWER AND SAILING YACHTS AT STRICTLY SAIL PACIFIC, APRIL 7-10



OCEANIS 31



OCEANIS 55



SWIFT TRAWLER 34



OCEANIS 45



OCEANIS 38



SENSE 50

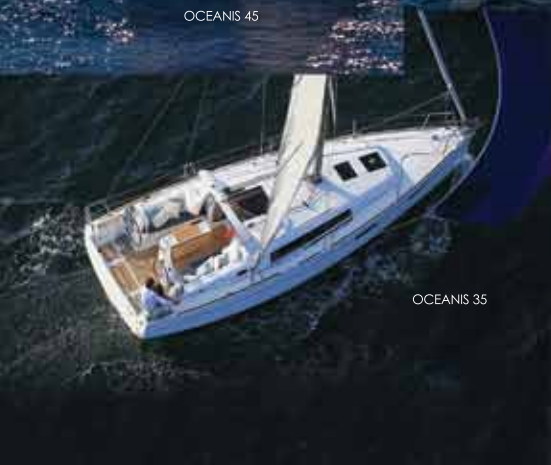

OCEANIS 35



BARRACUDA 7



New Boat Showcase

DEHLER 42

This new model will be making her big North American debut at this year's Strictly Sail Pacific! The mission to offer pure sailing enjoyment is underlined in this model with different expansion levels, which enables the Dehler 42 to be transformed from a comfortable touring version into a competitive sporty model with a wide range of options.



HANSE 455

At home on the high seas, the 455 has everything you would expect from a perfect cruising yacht. This Judel/Vrolijk creation has the largest cockpit in its class, giving owners enough space to sail in comfort and spend relaxing hours in port. Using Hanse's signature self-tacking jib and deck layout – with all lines led aft to the helm – the 455 is easy and safe to operate, and designed for short-handed sailing.



MOODY 54 Deck Saloon

The Moody 54 Deck Saloon will be making her Northern California debut at Strictly Sail Pacific 2016. German innovation and design at its finest, this beauty combines everything you want in a cruising sailing yacht. This is a boat with an expansive cockpit, tremendous safety and security features, Moody's 'Living on One Level' concept, and amenities you would expect on a mega yacht.



CATALINA 385

Third in the acclaimed Catalina 5 Series Yachts, the 385 is an evolution of successful design features and proportions. Moderate beam carried well aft for a spacious cockpit, moderate freeboard for reduced windage and pleasing appearance, and an innovative and beautiful finished interior. The new 385 combines all the best elements of successful previous models in the 5 Series.



BENETEAU SENSE 50

With the Sense line, Beneteau sets out to provide the best bluewater cruiser for families; a common-sense liveaboard that is completely unique in the layout of its accommodations, the openness of its cockpit and the comfort of its living spaces. Each of the Sense features was designed to enhance comfort and maximize enjoyment on the water for everyone aboard. Ideal for families longing for offshore cruising.



JEANNEAU SUN ODYSSEY 41DS

Hit the docks and discover Jeanneau's Sun Odyssey 41DS. Designed for relaxation and comfort, the Sun Odyssey 41DS also delivers the thrill of responsive sailing. A spacious owner's cabin aft features a private head and shower compartment and plenty of storage for life on board, offering owners all the luxury of a 45-foot sailboat. Whether you're cruising, living aboard or entertaining friends, you will find functional and aesthetic design in every detail.





Moody®

DECKSALOON 54



living on one level & luxurious comfort

easy handling & perfect control

safety & seaworthiness

handcrafted quality & high-tech



AC41

AC45

DS45

new DS54

DS62

Moody Boats . Newburyport MA . Ph +1 (0) 978 239 6568 . dbrophy@moodyboats.com
Berthon USA . Newport RI . Ph +1 (0) 401 846 8404 . sales@berthonusa.com
JK3 Yacht Sales & Service . San Diego . Ph +1 (0) 619 224 6200 . jeff@jk3yachts.com

www.moodyboats.com

Cool Products

Strictly Sail Pacific is pleased to feature the following products from some of our exhibitors. Please visit their booths and experience them for yourself! For a complete list of products at Strictly Sail Pacific, see the show website at www.strictlysailpacific.com.

NEW ENGLAND ROPES – Spinnaker Furling Line

Spinnaker Furling Line from New England Ropes is a stiff, compact, high-tech rope with a tightly-braided polyester cover and a multi-stage-braided aramid core. This tight construction yields a highly torque-resistant furling cable which can be terminated using mechanical end fittings. Size range 9mm–15mm.



Spinnaker Furling Line can be used with any top-down furling system. It is highly engineered to resist torque allowing it to transfer rotation from the furler at the

bottom of the system to the swivel at the top of the sail and at all points in-between. This allows for faster and more even furling of large headsails, gennakers, code zeros and spinnakers.

LIFELINE® MARINE BATTERIES Premium Deep Cycle AGM Technology

Manufactured entirely by hand – from start to finish – and built to military specifications. As a family owned



and operated U.S. manufacturing facility, we take pride in all of our products. Our quality materials and craftsmanship put us on top in the AGM battery market. Lifeline® is a

powerful name in the battery industry with world class performance and customer service.

CHART Metalworks – Pewter Money Clip

1 ½" face, spring closure to accommodate ample cash, credit and business cards. Made in Maine, USA, our pewter-toned finish is a durable imitation rhodium plate for years of tarnish-free enjoyment. Quality; one of a kind.



WEEMS & PLATH – The Only Alternative to Traditional Flares

The SOS Distress Light is the only LED Visual Distress Signal Device that meets U.S. Coast Guard requirements to completely replace traditional pyrotechnic flares. Unlike traditional flares, this electronic flare never expires, which solves the challenge of flare disposal.

This floating electronic flare can be handheld, tethered, or hoisted aloft. It runs up to 60 hours, unlike traditional flares which last minutes or less.



EURO MARINE – Antal Double V-Grip Jammer

Antal's Double V-Grip Jammers, (DVJ) offers superior quality in a small and extremely powerful line-holding jammer.



The mechanism is based on Antal's successful V-Grip system and takes it one step further. The DVJ relies on two opposing V-shaped wedges which interlock, grasping the line and evenly distributing the load on four sides. The result is a jammer that offers increased surface area grip as opposed to the traditional two flat jaws.

VARIPROP – Feathering Propeller

Variprop is the finest automatically-feathering propeller available in the world today. The advanced design and precision engineering and manufacturing by SPW GmbH in Germany assures flawless performance.

- Near zero sailing drag
- Powerful thrust in head seas
- Incredible control in reverse
- And much more

See at the
AB Marine
booth



WHERE DO YOU GO FOR HIGH QUALITY BOAT REPAIR?

Come see
us at the
Strictly Sail Pacific
Booth #H5

April 7-10, 2016

Craneway Pavillion
Richmond, CA

The same place the USCG goes for superior craftsmanship, fixed pricing and scheduled deliveries. Bay Marine Boatworks is proud to maintain the vessels which help ensure the safety of all mariners.

DOESN'T YOUR VESSEL DESERVE
THE SAME ATTENTION TO DETAIL?

Photo by Mike Baird.

Our mission is to guarantee absolute satisfaction to every customer.



www.baymarineboatworks.com

310 West Cutting Blvd., Point Richmond, CA 94804

Tel. 510.237.0140 • Parts Tel. 510.234.7960

office@baymarineboatworks.com



Cool Products

SEABUNG™

Seabung™ is a simple device that allows you to seal a hole in a boat by using water pressure to your advantage as opposed to fighting it, as well as allowing you to check, repair or change a seacock without the need to lift the boat from the water. Launched at METS in Amsterdam in November 2014, Seabung™ won a Dame design award, and in 2015 the Freeman Pittman Award for Innovation.

Seabung™ is currently being carried on the Clipper Round the World Yacht Race soon to reach Seattle. Come see it at the Mechanical Advantage booth.

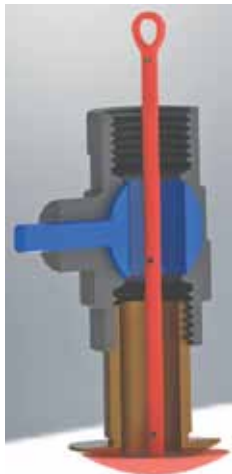

IMTRA'S LARGO TRI-COLOR LED LIGHT WITH BUILT-IN DIMMER SWITCH

Designed specifically to give the space-conscious boater a number of lighting options in a compact and affordable package, the DC-powered Largo LED light is a single, two-wire fixture with three color outputs: red, blue and white. An ideal LED replacement for halogen or incandescent fixtures, the 4.7-watt Largo's white LED is equivalent to a 30-watt halogen and is available in either warm white or cool white options. With a 96-degree wide-flood illumination area, Largo is perfect for a variety of general lighting applications. The blue and red LEDs protect a crew's vision in low light or night operations for offshore cruisers and trawlers. Designed and assembled in the USA, and protected by a five-year warranty.



ANDERSON WINCHES – Better Winches, Better Sailing

Beautifully elegant inside and out, Andersen sailboat winches are a reflection of the functional needs and aesthetic demands of top-quality sailing yachts worldwide. Developed using state-of-the-art production techniques that have been carefully refined for more than 60 years, each of our winches reflect a sincere dedication to offer the most outstanding performance from the highest quality winches to our customers.



KARVER FURLER – KF5

A furler is the ideal system to set and strike light sails. In a race utilizing multiple furlers for various sails, Karver offers the advantage of roller furling without the weight and windage of a conventional roller reefing system. K.F. Furlers optimize sail handling with minimal weight aloft. Karver is an industry leader in this concept offering a complete range of superior products for all sailors. Learn more at the Bainbridge booth.



NEW – WICHARD OFFSHORE KNIFE

Designed for high demands from the conditions of offshore sailing, the Wichard Offshore Knife offers a range of essential functions on board a boat. In addition to a high quality cut, the knife features high-visibility coloring, a locking blade, soft grip, one-handed operation, and is resistance to corrosion. The serrated blade easily cuts all types of modern ropes, including Dyneema®. Each knife is equipped with an adjustable wrist strap to help avoid losing your knife when in use.



NEW PRODUCT INTRODUCTION! Sail America and West Coast Sailing Bring You an Opportunity to Try Out the New RS Quest

The new RS Quest is a 14'1" dinghy developed specifically for sailing programs and families. Its wide, rotomolded hull is quite stable and much more durable than fiberglass. The spacious cockpit, modern rigging and optional asymmetrical spinnaker ensure an enjoyable and exciting day on the water for sailors of all skill levels.

During the Strictly Sail Pacific Boat Show, you will have the opportunity to sail the new RS Quest. Simply register online for a day and time that is convenient for you. There is no additional charge for this program. If you would like to be accompanied on your sail by an instructor, please let us know in advance. Life jackets will be provided.





**NEVER
LOOK BACK**

Little Nico
Designed by Shaw Yacht Design
Built by Van Munster Yachts
Powered by Doyle Stratis Ice

©Michaël Chittenden

STRATIS

A sail for every application. No matter what your yacht, Stratis provides the right fibre and surface for every application. From the hard out harbour and coastal racer, to luxury performance superyachts, when you've got Stratis GPX Performance Sails on board, the finish line is a whole lot closer.

www.doylestratis.com, www.doylesails.com or www.facebook.com/doylesails

Show Highlights

Plenty of Fun Things to Do and See!

From the sailing novice to the die-hard racer, Strictly Sail Pacific has something for everyone: the widest selection of sailboats and sailing accessories on the West Coast, an extensive seminar schedule, hands-on sailing clinics, live music and parties.

WELCOME TO THE ALL-NEW DISCOVER SAILING AT STRICTLY SAIL PACIFIC

Take a Sail or a Clinic with Discover Sailing

Whether you are a cruiser or a racer, thinking about the next boat or that next charter vacation – or looking to try out the latest sailboats offered and learn about their new technologies and sailing styles – check out Discover Sailing.

To help sailors get the most out of their boats and to feel confident when considering their next boat, we are featuring several hands-on on-the-water clinics led by some of the best instructors in the Bay Area. Pre-registration for these clinics is encouraged, and includes admission to the show for the day of the clinic. (An \$18/pp value.)

On these pages, you will find full descriptions for all of our Discover Sailing Programs being offered at Strictly Sail Pacific 2016. To learn more or to register for one of these clinics or free sails, go to www.strictlysailpacific.com.



ANCHORING

This two-hour hands-on clinic will introduce you to such techniques as picking up a mooring ball, setting an anchor properly, setting two anchors, anchoring bow and stern, Bahamian anchoring, Med mooring, selecting the right anchor configuration, what to do about a fouled anchor, the risk of rode in the prop and other issues. Our goal? A good, sound sleep the next time you spend the night at anchor. Your instructor will be a certified, licensed instructor from Tradewinds Sailing School and Club.

Thursday–Sunday, 4:00 p.m.
Limited to four people per clinic.
Online registration: \$125/pp
(\$150/pp for onsite registration.)

SAIL TRIM FOR CRUISERS AND RACERS

A half-day clinic designed to help you get the best performance out of your boat. You'll be sailing and trimming under the direction of the coach. Bring your gloves! Topics include: sail trim theory, angle of attack, speed and twist, speed and pointing, sail selection, genoa and main trim, downwind sailing under main and jib, downwind sailing with a spinnaker, and tacking and jibing. Sign up individually or bring your crew.

Thursday–Sunday, 9:00 a.m. and 2:00 p.m.
Online registration: \$150
(\$175/pp for all onsite registration.)
Additional crew member: \$95; Crew of six: \$495

CATAMARAN SAILING

During this three-hour clinic aboard a catamaran, you'll learn to maneuver a large cruising catamaran under sail and power. You will also learn about docking, anchoring, crew overboard, and the general systems of a large cruising cat. Your instructor will be U.S. Coast Guard-licensed master and ASA-certified instructor Dan Seifers. Offered in cooperation with Tradewinds Sailing School and Club, and Modern Sailing School and Club.

Thursday–Sunday, 10:00 a.m. and 2:00 p.m.
Limited to six people per class.
Online registration: \$150/pp
(\$175/pp for onsite registration.)

DOCKING

This two-hour clinic will enable you to control your vessel in close quarters maneuvering instead of the other way around. It will come in handy every time you depart or arrive at a dock. You will be doing all of the driving as you practice fairway turns and backing the boat, and a series of drills that will lead you to mastery of upwind, downwind, crosswind, portside-to, starboardside-to, bow-to and stern-to docking. Your instructor will be a certified and licensed instructor from Tradewinds Sailing School and Club.

Thursday–Sunday, 10:00 a.m. and 1:00 p.m.
Limited to four people per clinic. Online registration: \$125/pp
(\$150/pp for onsite registration.)



Marina CostaBaja, at the Gateway to the Sea of Cortez in La Paz, South Baja.

Marina CostaBaja's protected location, concrete docks and double basin design offers controlled access to 250 prime slips for vessels ranging from 30-200 feet.

OUR PRIME FACILITIES

Potable desalinated water • Secure dock boxes • Largest fuel dock in the area • Crew lounge
 Pump out service • 24 hour security • Laundry service

Visit CostaBaja, a master planned community and enjoy Golf or relax at the Beach Club or choose your future home among a variety of Condos, Villas and Townhouses.

Discover the most beautiful bays, islands and marine life in what is known as "The Aquarium of the World".



COSTABAJA
 Unique living on the Sea of Cortez
 marina • golf • residences

Gabriel Ley (Marina Manager)
 marina@marinacostabaja.com
 Toll Free 888-866-9394
 www.marinacostabaja.com

Show Highlights



TASTE OF SAILING

Join us for a four-hour sail on San Francisco Bay and along the way we will teach you as much or as little as you want about how to sail. We'll have a lively discussion about the types of sailing, the types of sailboats, and what it takes to become a competent and confident sailor. You'll be welcome to participate in steering the boat, trimming the sails, and making proper and safe decisions. Of course, we'll provide you with a complete explanation of the equipment on the boat and a thorough safety briefing. This sailing experience will be followed by a short social event so that you can review and relive your on-the-water experience with the friends you've made on board.

Thursday–Sunday, 9:00 a.m. and 2:00 p.m.

Limited to four people per sail. Online registration: \$150/pp, or \$250/couple. (\$175/pp and \$300/couple for onsite registration.)

If you would like to have a private family, friends, or corporate experience, please contact Gary Edelman, the Sail America Discover Sailing Director, at (414) 944-1550 to discuss your options – or you can email him at: discoversailing@sailamerica.com.

LAUNCH YOUR SAILING LIFE!

This one-and-a-half hour sailing experience is a great opportunity to experience the San Francisco Bay Area from the water, and learn a little about sailing. Your certified and licensed instructor will provide you with a complete safety briefing and a short discussion about how sailing actually works. Then you'll head out on the water. You'll learn to steer the boat, trim the sails, and how decisions are made for safe and fun sailing. At the end of your sail we'll give you a gift bag courtesy of Sail America and our partners. Offered in cooperation with Trade Winds Sailing School and Club, and Club Nautique.

Thursday–Sunday, 10:30 a.m., 1:00 p.m. and 3:30 p.m.

Online registration: \$95 p/p

CAST OFF FOR CRUISING

This 90-minute, on-the-water sailing program will introduce you to sailing and show you how easy it can be to make those dreams come true. You will cast off aboard a brand new Beneteau 31 sailboat with one of Club Nautique's award-winning licensed and certified instructors. This sailing experience will give you a taste of the wonderful experiences yet to come as you begin your cruising life. Offered in cooperation with Club Nautique.

If you have questions, or want to arrange a Cast Off For Cruising experience for a family or group, please contact the Discover Sailing office at (414) 944-1550.

Thursday–Sunday, 11:00 a.m., 1:00 p.m., and 3:00 p.m.

Space is limited to four people per sail.

Online registration: \$150

(\$175 for onsite registration.)

SAIL ON SAN FRANCISCO BAY, EXPLORE SCIENCE, HELP KEEP OUR WATERS SAFE AND CLEAN!

Join us for a fun-filled morning or afternoon of discovery sailing, aboard the 65-ft sailing research vessel, *Derek M. Baylis*. Working side by side with marine science educators, you will be able to formulate your own theories about the good, the bad and the ugly indicators of water quality, bio-diversity and marine health of San Francisco Bay. The program is structured to enrich the minds of all ages with hands-on ongoing research projects. In a fun and

engaging way, you'll be able to experience the scientific method by collecting, studying and recording data. Not only will you be helping to make San Francisco Bay and our oceans a cleaner place, but you'll learn how this can be done under sail. Our program is suitable for ages 9 and up, and for anyone interested in marine sciences and in keeping our waters clean. You will also have a chance to get behind the wheel and learn how to steer a sailboat and trim her sails. Offered in cooperation with Wylie Charters and the crew of the *Derek M. Baylis*.

We have special rates for school/science/scouting/similar groups of six or more. For information on our group rates, please call the Discover Sailing office at (414) 944-1550.

Thursday–Sunday, 10:15 a.m. and 2:15 p.m.

Online registration: \$95 for adults, \$65 for children 8–17, children 8 and under are free, but must be accompanied by their legal guardian. (Advanced registration is strongly encouraged as space is limited.)

DOCKSIDE MARINE SCIENCE PROGRAM 'BELLY BIOLOGY'

The Dockside 'belly biology' program is for anyone that wants to learn about the health of San Francisco Bay and our oceans, and who wants to help keep them clean, so that we can continue to enjoy sailing these waters. Participants will collect specimens from the dock and the water, and analyze them with the scientific equipment such as microscopes, dissolved oxygen meters, refract meters, etc. Offered in cooperation with Wylie Charters and the crew of the *Derek M. Baylis*.

If you want to schedule a special presentation for a school/STEM/REACH or other educational group, please contact the Discover Sailing office at (414) 944-1550.

Thursday–Sunday, 10:30 a.m. Runs continuously until 5:00 p.m. each day.

There is a suggested donation of \$15 for this dockside program, but no one will be turned away.

LAP OF LUXURY PROGRAM

Enjoy a romantic private two-hour sunset cruise for two on beautiful San Francisco Bay. Toast your special event with your favorite wine or champagne while enjoying a basket full of tempting gourmet treats. Continue your evening aboard the beautiful yacht for an unforgettable night of romance. After your sail, your luxury sailboat will be berthed at the remarkable Marina Bay Yacht Harbor. You'll be welcome to take advantage of all the amenities of the marina, including a short walk to restaurants. Or you can have meals delivered directly to the boat. Offered in cooperation with Trade Winds Sailing School and Club.

Wednesday–Saturday, 6:00 p.m. – and feel free to 'sleep in' as you're welcome to stay on-board until 9:00 a.m.

Space is limited to one couple per evening.

Online registration: \$350 per couple

(Includes the two-hour sail, a gift basket of wine and gourmet treats, tickets to the Strictly Sail Boat Show for the day of your sail and the following day.)

Show Highlights

GARY MULL CELEBRATION

Gary Mull was one of the 20th century's most prolific and influential – not to mention innovative – sailboat designers. The breadth of his design portfolio is astounding especially given his relatively short career, as Mull died in 1994 at the age of 55.

Boats Mull designed include some of the most successful production boats including the Santana 22 and 27, the Ranger 23 along with the entire line of Rangers, Newport 30, Kalik 40 and 44-2, the Freedom 36, 42 and 45, Moore 30, Orion 50, and the Independence. He co-designed the Capri 22 of which nearly 1,000 were sold. His custom and racing boats were often world champions.

Gary Mull trained many of today's hottest naval architects. If you sail in San Francisco Bay, chances are very good you have either sailed on a Mull-designed or influenced boat, or been passed by one.

Join us Saturday from 11:00 a.m.–Noon and at 1:00–2:00 p.m. in Booth R22 for informal panel discussions about Gary Mull and his work.

All day Saturday we'll have a variety of Mull-designed boats you can board. Experts will be available to answer your questions about the boats.

SAIL AMERICA FUN REGATTA – SAIL WITH AN EXPERT!

Sail America will host a Fun Regatta designed to provide you with an opportunity to sail with an expert.

The Regatta will start with a skippers' meeting at 2:30 p.m. on Saturday, April 9. As part of online registration, you'll have a choice to choose the expert you want to sail with, or to be assigned one randomly.

Racing will begin at 3:00 p.m.

There are only a total of 24 open slots, so register early to make sure you get your choice of experts.

The winners will receive fabulous prizes and, in the end, everyone wins as 100% of your registration fee will support Sailing Education Adventures (SEA).

You can register online at www.strictlysailpacific.com.

AUTHORS' CORNER

Stop by the Authors' Corner and pick up a great new read from your favorite sailing author. Chat with the experts, receive some great advice for your next sailing trip, get a signed book, and hear a tale or two about any number of sailing topics and adventures. Open during show hours.



Mathiesen Marine

For all of your electronics and electrical needs



Raymarine
BY **FLIR**



Visit the Raymarine Mobile Showroom to try the latest technology & Our booth *CLOSE BY* for the *BEST SHOW DISCOUNTS & REBATES!!!!*



WIN a Raymarine DragonFly!!! Giving away one each day!!!

***RIGHT INSIDE THE MAIN ENTRANCE* at Corner Booth B1**



Professional Sales, Design, Troubleshooting, Installation, Consultation, Education & Surveys for Electronics, Electrical, PC & Mac Based Navigation, Corrosion Issues, Electric Drive Conversions, Solar & Wind Power Systems + More

Emery Cove Yacht Harbor Showroom 3300 Powell Street, Emeryville, CA
Tuesday - Saturday 9:00 a.m. to 5:00 p.m.

510.350.6622

www.MathiesenMarine.com

Show Highlights

OPENING CEREMONY

Join us Thursday, April 7 at 10:00 a.m., with the Mayor welcoming Strictly Sail Pacific to Richmond, CA. As we are all excited for this new relationship, come show your support and hear more exciting details on how Strictly Sail Pacific and Richmond plan to carry out this partnership while also growing with the local area. Be one of the first to arrive and you could win a complimentary ticket to the show that day!

MODEL BOAT RACING

Join members of the Sacramento Model Yacht Club (SMYC), Elk Grove Model Yacht Club, San Francisco Model Yacht Club, and the North Bay RC Sailing Clubs (NBRCS) each morning at 11:00 a.m. and again at 3:00 p.m. to enjoy the racing in at least three classes – Santa Barbara 70", Canterbury J's 60", and Infinity 54" – in the Inner Harbor Basin at the show. Watch as the mini yachts make their way through the Basin, keeping you on the edge of your seat for the win. We will also have beginner boats to sail along with an 8-1/2 foot J class replica of *Shamrock* on display as well as sailing.

STAND UP PADDLE BOARD RACE – Hosted by 101 Surf Sports

Rise and Shine! Come participate or view the Stand Up Paddle Board Race in the Inner Harbor Basin on Saturday, April 9. The races will kick off with registration beginning at 8:00 a.m., follow up with a skippers meeting at 9:30 a.m., with the racing beginning at 10:00 a.m. With multiple races segmented by experience, all races will wrap up at 1:00 p.m. Interested? Contact 101 Surf Sports at www.101surfsports.com or call (415) 524-8492.

FREE HOURLY SEMINARS

Harken and *Cruising Outpost* are the presenting sponsors for the seminars given by sailing experts and industry leaders. Whether you are getting started in sailing, planning your dream cruise, preparing for the Pacific Cup, or looking to get the most out of sailing on San Francisco Bay, there is a seminar for you. Enjoy seminars on sailing destinations, weather, tides, cruising on a budget, sail trim, voyage planning, electronics, the Baja Ha-Ha, cruising for couples, catamaran cruising, storm strategies and more. With many unique topics, you may want to spend the entire weekend. See page 26 to learn more about featured speakers, and visit www.strictlysailpacific.com for a full schedule of free seminars.

And watch for Strictly Sail Pacific's Helly Hansen Raffle boxes located throughout the show!

MARINA BAY YACHT HARBOR



New Home of
**STRICTLY SAIL
PACIFIC**
April 7-10

***Come For the Show –
Stay For the Season!***

Easy Access by Land or Sea!

Ample Parking



(510) 236-1013

www.MarinaBayYachtHarbor.com

Afterguard Sailing Academy

the school with heart

See us at
Booth I-11



Estuary, Bay & Ocean ASA Courses



Couples/Families can learn together



HS and College sailing programs



Fun Practice sails - Day or Sunset

ASA Sailing School, Complete Learn to Sail packages plus great fill in classes, Challenges welcome - **Best rates on Bay for ASA**
Old salts learn new tricks - Docking & Crew Overboard, Ocean...

Take a look at www.afterguard.net or call (510) 535-1954
- Central Basin Marina - 1853 Embarcadero, 2B, Oakland CA 94606 -

MAZATLAN... YOUR MEXICO CRUISING HOMEPORT



CRUISE MEXICO WITH MARINA EL CID STYLE!

A clean, friendly, first class marina with a beautiful climate and rich local culture.



www.elcid.com

011-52 (669) 916-3468
gcevallos@elcid.com.mx

NEW ENGLAND ROPES
A TEUFELBERGER BRAND

**Quality. Innovation.
Performance.**

Achieving excellence is a team effort. That is why we partner with sailors from around the world, Olympians, leading riggers, and retailers to create innovative, high quality products that never compromise on strength, durability, and performance.
www.neropes.com

Visit Us at Booth G9

NEW ENGLAND ROPES
A TEUFELBERGER BRAND

Advance Seminars

Advance Registration and Fee Required

All Seminars on pages 22-23
given by Lee Chesneau

Tropical Cyclone Basics and the 1-2-3 Rule for Avoidance Workshop

Location: Seminar Center, Seminar Room E

Date: Saturday, April 9

Time: 3:00 p.m.–6:00 p.m.

Cost: \$65

Register at www.strictlysailpacific.com

This seminar and workshop will discuss the basics of tropical cyclone (hurricane) systems and their impacts on the Eastern North Pacific Ocean (Mexican West Coast), and sometimes even Hawaii. Tropical cyclones (hurricanes) are different in size and dynamics than their middle latitude (30-60 degrees latitude) cousins, as both provide their challenges to all boaters. The environmental conditions for tropical weather systems, however, are different from those of the middle latitude as well, so this particular seminar will complement the free seminar Assessing Your Marine Weather Self-Reliant Skills.

The tropical North Eastern Pacific and North Atlantic Oceans and Gulf of Mexico are not limitless. Furthermore, there are also hostile conditions for these tropical systems moving northward from the warmer waters of the tropical and subtropical latitudes into the cooler waters of the Eastern North Pacific Oceans, which can be as far south as the latitude of the central Baja Peninsula. Keep in mind also that the

lead time for a boater's avoidance and strategies will be different in time and space over open high seas waters than over the coastal areas. Thus, we introduce the 1-2-3 Rule for avoidance, concentrating on the 34-knot wind radii. We will also breakdown the Tropical Cyclone (Hurricane) Message, known as the TCM, for interpretation, clarity and application. The hurricane season in the Eastern North Pacific is earlier than the North Atlantic, beginning May 15 and ending late November.

The hands-on portion of this workshop is a practical exercise that will include:

- Exercise: Interpreting the Tropical Cyclone Message (TCM) and constructing a 'Danger Area to Avoid'.
- Exercise: Applying the 1-2-3 Rule for eastern North Pacific, for hands-on practice for Tropical Cyclone (Hurricane) avoidance.

Although this seminar/workshop does not have a prerequisite, you still should consider attending the free seminar Assessing Your Marine Weather Self-Reliant Skills. See Strictly Sail Pacific Free Seminars schedule and description.



LEE CHESNEAU

Surface Pressure Chart Workshop

Location: Seminar Center, Seminar Room E

Date: Sunday, April 10

Time: 8:00 a.m.–11:00 a.m.

Cost: \$65

Register at www.strictlysailpacific.com

This three-hour reinforcement workshop takes a closer look at and examines more in-depth surface pressure charts.

Specifically:

- Attendees will practice determining true wind direction and speed barbs from a surface pressure chart depicting lows and highs only, as initially discussed in the free seminar, Assessing Your Marine Weather Skills.
- There will be a follow up on detailed discussions on the various symbols depicted on a surface pressure chart not covered in the free seminar. Examples such as the characteristics and features of low and high pressure systems inclusive of fronts, troughs, ridges, squall lines, shear lines, monsoon trough, the ITCZ, and frontal character change symbols.
- There will also be a review of cloud groups and types associated with the aforementioned features, as well as precipitation classification affecting visibility constraints.
- There will be a follow up reinforcement exercise built around the discussion's points made of aforementioned surface pressure chart symbols.
- There will be a practice learning exercise to consolidate the difference between 'Issued' and 'Valid'. This is important to understanding the 24-hour interval tracking of directional movement and intensity trends of the low and high pressure centers on all surface pressure analyses and forecast charts from the NWS's Ocean Prediction Center (OPC).
- There will be a follow up hands-on exercise of the 48-hour tracking of surface low and high pressure systems depicted on surface pressure charts.
- Based on reviewing additional surface pressure analyses and forecast chart symbols, there will be a follow up practice exercise on being able to identify the specific weather conditions associated with the map symbols, such as associated clouds and associated visibility restricting weather conditions. (Fog or precipitation types; rain, showers or thunderstorms.)
- Ref: the NWS marine advisory watch and warning program. There will be a scenario for attendees to consider strategy options before – as well as after – leaving the dock.

Prerequisite: Attend free seminar Assessing Your Marine Weather Self-Reliant Skills. See Strictly Sail Pacific Free Seminars schedule and detailed description.

Advance Seminars

Understanding the 500 mb Chart Workshop

Location: Seminar Center, Seminar Room E
Time: 11:30 a.m.–2:30 p.m.

Date: Sunday, April 10
Cost: \$65

Register at www.strictlysailpacific.com

We broke down the different components of the 500 mb chart, considered to be the holy grail of weather forecasting from the earlier free seminar Unlocking the Mystery of the 500 mb Chart. Now we will go into deeper discussion to further your understanding of this important upper-air chart. Specifically, in addition to the 500 mb station plot, we will delve more into the 500 mb components; why altitude versus pressure, iso-height contour spacing, wind barb minimum values and their spacing, as well as iso-height labeling. In this workshop you will specifically learn:

- To identify upper-level troughs and ridges as depicted on 500 mb charts.
- Vorticity concepts, which results in upward and downward motion of air that leads to the formation of surface low and high pressure systems, where sea level – your boat – lies.
- How 500 mb has direct impact, specifically where surface low and high pressure weather systems originate, intensify, weaken and move. (Direction and speed of motion.)
- What a weather pattern is in regards to the now-familiar household name Pineapple Express, the Polar Vortex, and how and why surface high and low pressure systems move rapidly from West to East, from South to North or vice versa, in between, or not even move at all for days on end.
- To identify and recognize through a practice hands-on exercise, the four basic flow patterns which are well depicted on 500 mb charts.
- To develop a culture of accessing 500 mb charts and their companion surface pressure charts. This will allow one to clearly see their connected inter-relationships.
- To use and exercise the A, B, C, and D zones associated with a 500 mb chart (as discussed in detail in Heavy Weather Avoidance by Chen and Chesneau. (www.chesneamarineweather.com/?p=214))

Prerequisites: Attend the free seminars Assessing Your Marine Weather Self-Reliant Skills and Unlocking the Mystery of 500 Mb Charts. See Strictly Sail Pacific Free Seminars schedule and detailed description.

RIGGERS LOFT

A Wine Tasting Destination on the Bay!

Come to the Riggers Loft Wine Company for fabulous wine tasting and unparalleled panoramic views of the bay. You'll be greeted by our knowledgeable and professional staff and encouraged to enjoy the comfortable, relaxed atmosphere of our tasting room inside a working winery. Sip on award-winning wines from three wineries as well as artisan cider.

Riggers Loft tasting room hours:

Thursday 4:00 - 9:00pm | Friday 4:00 - 9:00pm
Saturday Noon - 9:00pm | Sunday Noon - 6:00pm

R&B
CELLARS



CARICA
WINES

FAR·WEST
Cider Co.

For more information, call 510-233-2065

WINE COMPANY

1325 Canal Blvd. Richmond, CA 94804

Advance Seminars

Advance Registration and Fee Required

Integrating Marine Weather and Cruise Decision Making Workshop

Lee Chesneau

Location: Seminar Center, Seminar Room E

Date: Sunday, April 10

Time: 3:00 p.m.–6:00 p.m.

Cost: \$65

Register at www.strictlysailpacific.com

Offshore blue water cruising on the high seas always involves receiving extended marine weather forecasts issued from NOAA's NWS or other government agencies such as Environment Canada or Japan's Meteorological Agency (JMH). For this workshop, we will delve into integrating the core weather charts for vessel forecasting and route decision making, inclusive of 500 mb, surface pressure, and wind/wave analysis and forecast charts obtained from the NWS's Ocean Prediction Center (OPC). This workshop will utilize these core products discussed in the previous free seminars and pre-paid workshops, and practice a virtual voyage plan.

- First, we will discuss concepts utilized in long distance voyage planning for both North Pacific and Atlantic Oceans – from pilot charts to graphical and text-based marine weather forecasts.
- We will then practice the importance of developing a culture documentation and verification of OPC's 48/96-hour Graphical Forecast Verification Page.
- Utilizing the Graphical Pacific Briefing Page from the OPC, we'll get an understanding of synoptic scale weather through five days (120 hours) by the integration of surface pressure, 500 mb, and wind and wave analysis and forecast charts.
- We then tie that into the local, offshore and high seas marine weather forecasts through five days, along with the Marine Interpretation Message from the OPC.
- Finally, we'll plan a North Pacific Ocean virtual voyage from Tacoma, WA to San Francisco, then onto Honolulu, Hawaii.

Prerequisites: Attend all the free seminar topics and companion pre-paid workshops. See Strictly Sail Pacific Free Seminars and Advance Seminars' schedules and detailed descriptions.

Couples Cruising Seminar

Jeff Grossman and Jean Levine, Two Can Sail

Location: Seminar Center, Seminar Room E

Date: Saturday, April 9

Time: 8:00 a.m.–5:30 p.m.

Cost: \$195/pp; \$325/couple

Register at www.strictlysailpacific.com

This seminar will help you learn how to take the drama out of your dream, from choosing the right boat to sailing away together in harmony, and is hosted by Couples Instructors and lifelong cruisers Jeff Grossman and Jean Levine.

Two Can Sail Couples Cruising Seminar will give you both the tools and perspectives you need as a couple to safely pursue the cruising lifestyle. We have assembled an outstanding group of marine professionals who have varied experience and background to present you with a balanced educational experience. Who are the presenters? They are couples who are also captains, ASA instructors, authors, marine surveyors, and a meteorologist. Couples attending will receive a pair of tickets to the boat show on Sunday, and one lucky couple will win a SPOT Messenger provided by SeaTech Systems.

This is not designed to be a whole day of power point presentations. We balance the hard data with some fun, lots of good information mixed in with some sea stories and fantastic photos. All of us sharing our expertise to help make the dream a reality for both of you.

Two Can Sail is sponsored by: *Blue Water* Sailing Magazine, SeaTech Systems, American Sailing Association (ASA), Massey Yachts, and Weems & Plath.



JEFF GROSSMAN & JEAN LEVINE

The final seminar schedule can be found at
www.strictlysailpacific.com.

Advance Seminars

Advance Registration and Fee Required

US Sailing Four-Hour Coastal Safety at Sea Seminar

Moderated by Chuck Hawley,
Chairman of the US Sailing
Safety at Sea Committee

Location: Seminar Center Room E

Date: Saturday, April 9

Time: 9:00 a.m. to 1:00 p.m.

Cost: \$75. US Sailing members receive a \$5 discount.
Includes free admission to the show.

Seating is limited.

Register at www.strictlysailpacific.com

Want to become a better coastal sailor? Want to feel more comfortable as you venture outside the Gate and down the California Coast? US Sailing's Coastal Safety at Sea Seminars are intended for both racers and cruisers who want to improve their offshore safety knowledge.



Topics include:

- Man Overboard Recovery
- Emergency Communications
- Search and Rescue
- Hypothermia
- Breaking Seas
- Personal Safety Gear

Many local races now require attendance at Coastal Safety at Sea Seminars.

Chuck Hawley is a well-known speaker and marine safety expert in the Bay Area. Chuck worked for West Marine for more than 30 years, and now serves as the Chairman of the Safety at Sea Committee for US Sailing. He appears in more than 500 videos on a variety of marine safety and product selection videos on YouTube, and has recently completed four educational videos on Safety at Sea for US Sailing. His 40,000 miles at sea have taught him to be creative in solving issues regarding boat systems, navigation, safety and rigging.



SVENDSEN'S BOAT WORKS

LOW BOAT SHOW PRICING!

Come see our friendly staff inside the crane way pavilion for all of your boating needs!

Gill Clothing

Gill



Imtra Corporation

imtra



Mustang Survival

Mustang Survival is the leading supplier of quality flotation and personal protective equipment to the most demanding maritime customers including commercial Mariners and Recreational boaters.



Lehr Propane-Powered Outboard Motors

LEHR



OPEN 7 DAYS A WEEK!

Chandlery & Rig Shop / 510.521.8454

info@svendsens.com / www.svendsens.com

1851 Clement Avenue, in the Alameda Marina

Free Seminars

SPONSORED BY

HARKEN

**CRUISING
OUTPOST**

Kame Richards

Kame Richards is a sailmaker and sail designer at Pineapple Sails, which he co-founded in 1973. Pineapple Sails makes both racing and cruising sails, building them from start to finish at their facility in Alameda, CA. Kame's racing experience covers San Francisco Bay, the California coast, multiple Hawaii and Mexico races, as well as races in the Great Lakes, Florida, Texas and Europe. He has cruised in Mexico, New Zealand and Australia. He has a well-established reputation as a lecturer on all aspects of sailing. Kame attended UC Berkeley, majoring in geophysics.



Bob Bitchin

Since the early '60s, adventure has been a way of life for Bob Bitchin. He worked as a traveling companion and bodyguard for famous motorcycle daredevil Evel Knievel, then, in the early '70s, he started sailing. For more than 30 years, he lived aboard sailboats and cruised most of the Pacific and Central America. In 1996, he created *Latitudes and Attitudes* magazine. More recently, Bob and his wife Jody created a new title, *Cruising Outpost*. He has written seven books: *Letters from the Lost Soul*, *The Sailing Life*, *Brotherhood of Outlaws*, *BIKER*, *Emerald Bay*, *King Harbor*, and *Starboard Attitude*.



Arnulfo "Fito" Espinoza

A Tijuana native, Espinoza has 20 years experience as a Dockmaster in Ensenada's Marina Coral, a favorite destination for boaters making their first stop in Mexico. Making sure everybody has the correct paperwork to clear in to the country is an obligation he takes seriously. Recently, Espinoza collaborated with the Mexican Tourism Board to promote Mexico's nautical destinations at several boat shows on the West Coast.



Lee Chesneau

Lee Chesneau is a highly-seasoned senior marine meteorologist with a distinguished 38-year career in maritime weather forecasting, ship routing, and writing. He's a keynote speaker at seminars and a certified U.S. Coast Guard STCW Basic and Advanced Meteorology Instructor.



The Best In Top Quality
Marine Products. Since 1917.

15242 Transistor Lane, Huntington Bch, CA 92649
800.433.0101 www.bainbridgeintusa.com

LIFELINE
...the heart of your system®
PREMIUM AGM BATTERIES

Crafted for quality in the U.S.A.

150 AMP hour group 30

The only AGM L-16 400 AMP hour completely manufactured in the USA.

LIFELINE BATTERIES
292 East Arrow Highway, San Dimas, CA 91773-3359
(800) 527-3224
www.lifelinebatteries.com

Free Seminars

Jeff Grossman & Jean Levine

Both Jeff and Jean are 100GT Masters and ASA-Certified Sailing Instructors. Jeff holds an Electrical Engineering degree and Jean is an Accredited Marine Surveyor, a member of the Society of Accredited Marine Surveyors (SAMS), and is ABYC Standards Certified. Together, they assist couples in realizing their sailing dreams through their business, Two Can Sail.



Sarah & Will Curry

They began talking about an offshore sailing adventure on their first date and, despite their similar personalities and dreams, they had very dissimilar boating experiences. Will had already sailed offshore, but Sarah didn't know the difference between a sheet and a halyard! Since setting out to accomplish their dream in 2012, they've voyaged thousands of miles together, been scared, been amazed, and have done things they never imagined.



Wendy Hinman

Wendy Hinman is a freelance writer with an insatiable curiosity and a natural inclination to share her discoveries. She loves stories; telling them, writing them, reading them and editing them. And she has plenty of engaging stories to tell – some serious, some not so serious.

After years trotting the globe for business and vacation travel, she instigated a waterborne adventure, sailing 34,000 miles over seven years with her husband on a 31-foot boat. She even managed to return sane (or so she thinks), still married and innocent of plotting murder. Along the way, she shared many of their (mis)adventures online and in magazines. Yet many still remained untold. Her hit book, *Tightwads on the Loose: A Seven-Year Pacific Odyssey*, details her seven-year adventure afloat.



Thomas Perry

Thomas holds a U.S. Coast Guard 100-Ton License with Towing and Sail endorsements. STCW certified, he's also certified by US Sailing to teach all curriculum courses including Coastal Passage Making – and he's one of Club Nautique's Lead Instructors, partly because of the number of students he's certified as Coastal Passage Making Sailors.



Captain Perry has taught for Club Nautique since 2006 and has logged more than 100 days on Club Nautique Coastal Passage Making classes. He is the owner of a 52-footer that he sails on the Pacific Coast every month of the year.

Club Nautique
You're at the helm!®

Club Nautique has changed my life! Thank you so much for everything that you guys do! I can't imagine life without sailing anymore... and I don't have to!
Ed Moss - Ultimate Member

Award Winning Sailing School
The most thorough beginner to offshore sailing program in the country

Impressive Charter Fleet
The largest, newest, best-equipped fleet of sail & powerboats on the Bay - Period

US Sailing Certification Standard
We are certified by US Sailing - the national governing body for sailing

Membership Benefits
Discounted Charters, Discounted Classes, Yacht Club Membership, Events & Cruises

Two Great Locations
Alameda & Sausalito

Visit us at booth J16 or in the water at the Strictly Sail Boat show!

Alameda 510-865-4700
Sausalito 415-332-8001
www.clubnautique.net



Scan here for current special offers

Let's Party

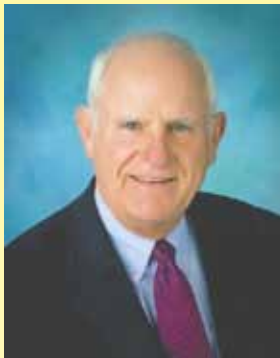

Opening Ceremony

Thursday, April 7 at 10:00 a.m.

Join us Thursday, April 7 at 10:00 a.m., with the Mayor welcoming Strictly Sail Pacific to Richmond, CA. As we are all excited for this new relationship, come show your support and hear more exciting details on how Strictly Sail Pacific and Richmond plan to carry out this

partnership while also growing with the local area. Be one of the first to arrive and you could win a complimentary ticket to the show that day!

Baja Ha-Ha, Pacific Puddle Jump and Circumnavigators' Reunion

Friday, April 8, from 6:00 to 8:00 p.m.

The crew of *Latitude 38* invites all Baja Ha-Ha veterans, Pacific Puddle Jump vets, and West Coast circumnavigators – plus anyone who wishes they were, or hopes to be someday – for a reunion party on Friday, April 8, at *Latitude 38's* Strictly Sail Pacific booth #C1. Swap some tall tales about cruising Central and South America, the Caribbean, and the South Pacific, and see who's completed a circumnavigation. *Latitude 38* will bring some snacks and beverages. You bring your smile, dreams, and your memories.

Latitude 38



Please visit
www.strictlysailpacific.com
for the latest show news and updates.

Celebrate TGIF

Friday, April 8, from 6:00 to 8:00 p.m.

Friday evening spells extra fun as exhibitors kick back and throw one big party for attendees. Show tents and booths are lively and full of great opportunities for sailors seeking the best deals, all while you're having a terrific time. Start the weekend with a bang at Strictly Sail Pacific!



Don't Miss the Cruisers' Party

Saturday, April 9, at 6:00 p.m.

More than a dozen years ago, Bob Bitchin and Jody of *Cruising Outpost* created the Cruisers' Party at Strictly Sail Pacific. Cruisers come from all over to enjoy this annual celebration of the cruising lifestyle. Eric Stone will be live and in concert, and free beer, wine, soft drinks and pizza will be available. Great raffle prizes, with Grand Prizes from Spectra Watermakers, Dream Yacht Charter in Martinique, and WinchRite®!

The event is free and open to all show attendees and exhibitors. It starts when the show closes at 6:00 p.m. You must be in the show prior to show closing to attend. Be part of the biggest, most fun sailing party of the year!

**CRUISING
OUTPOST**



SAN JUAN ISLANDS



Weeklong Learn-N-Cruise

Fly to Bellingham, WA, and complete your American Sailing Association Basic Sailing through Bareboat Certification during a liveaboard week exploring the spectacular San Juan Islands. Tuition \$1850 (including food) – plus \$200 Off with *Latitude 38* Special! (Roundtrip air approx. \$350.)

No experience like this for the price in the SF Bay Area!



CHARTER
35 Exceptional Yachts
from 34 to 46 feet

Over 35 Years of Sailing Excellence

We certify more Bareboat Skippers than any other school on the West Coast!

1-800-677-7245 • www.sanjuansailing.com



-EXPLORE-
The Sea of Cortez



www.golapaz.com



México
LIVE IT TO BELIEVE IT
visitmexico.com

**Yacht Insurance as
unique as your yacht**



**Look for us at Booth R21 at
Strictly Sail Pacific!**

*Pantaenius America Ltd is a licensed insurance agent licensed in all 50 states. It is an independent corporation incorporated under the laws of New York and is a separate and distinct entity from any entity of the Pantaenius Group.

PANTAENIUS
Yacht Insurance

USA* · Germany · Great Britain · Monaco · Denmark
Austria · Spain · Sweden · Australia

inquiries@pantaenius.com · pantaenius.com

Exhibitors by Brand

In Alphabetical Order

48° North

AB Marine

ACE Insurance

ACR Electronics

AIRX

AME Captain's Licensing

Absolute Outdoor (Onyx)

Safety

Afterguard Sailing

Academy

Air Head Toilet /

EOS Design

American Battery

Company

American Sailing

Association

Ameriprise Financial

Services

AnchorRescue

Recovery System

Andersen Winches

Antal

Aurinco, Inc.

Auto-Helm Windvane

Autoprop Propeller

Autotether

B&G Navico

Bainbridge International

Balmar

Bareboat Cruising

Made Easy

Bay & Delta Yachtsman

Magazine

Bay Area Boat Loans /

Intercoastal Financial

Group

Bay Marine Boatworks, Inc.

Beneteau America

Beta Marine West

Boat Leather

Boatswain's Locker

BoatU.S.

Books by Bob Bitchin

Brickyard Cove Marina

Brown, Bruce, &

Associates

CHART Metalworks

CNB / Lagoon

CPT Autopilot

C Cushions

C-Pod

Cali-Optics Importer

California Corrosion

Concepts

California Department

of Boating and

Waterways

Cape Hatteras Marine,

Inc.

Carefree Boat Club of

SF Bay

Catalina Yachts

Catamaran Company, The

Catlin Insurance

Chafe-Pro

Click Heat, Inc.

Climma

Clipper Round the

World Yacht Race

Clipper Ventures

Club Nautique

Coastal Climate Control

(Veco)

Coastal Cruising Made Easy

CoolBlue Refrigeration

CopperCoat USA, LLC

Craneway Pavilion

Cruise RO Water

and Power

Cruising Catamaran

Made Easy

Cruising Outpost

Cruising Yachts

Curtis Instruments

Custom Marine Products –

Solar

Cutco Cutlery

DC Power Alternators

Dan Buoy

Dash Hemp Santa Cruz

Davis Instruments

Day's Catch, The

Dehler Yachts

Deka Battery

Delta Sailing School

DeWitt Artwork

Discover Sailing

Doyle Marine

Doyle Sailmakers

Drainman

Dream Yacht Charter

Dubarry of Ireland

Dutchman

ECHOTec. Watermakers

Easom Racing and

Rigging

Eclectic Energy Wind &

Hydro

EisenShine

Elco

Electric Propeller

Company

Electric Yacht

ElectroProp

Ella Vickers Recycled

Sailcloth

Espar

Essex Credit

Euro Marine Trading, Inc.

Evolution Autopilots

FLIR Systems, Inc.

FSE Robline

Farallone Yacht Sales

Fiorentino Para Anchor

First Mate Marine, Inc.

Fisher ISUP

FlopStopper.com

Forespar

Forget About It For Boats

Frigoboat

Furuno

Fusion

Future Fibre

GAM

GC Rigging

and Composites

GEICO Marine

Garhauer Marine

Garmin USA

Gemini Catamarans

Genasun

Gill Foul Weather Gear

Globalstar

Glomex

GoFree

Gori Folding Propellers

H&C Marine / CEMA

HPEVS

HamiltonJet

Handcraft Mattress

Company

Hanse Yachts

Harken

Hawk Epoxy

Helly Hansen

Helmut's Marine

Henri Lloyd

Henry's Marine and More

Hirschfeld Yachts

Hobie Kayaks

Hobie Sailboats

Hook & Moor –

Boat Hook

Hydromax Marine

Fuel Cell

Hydrovane International

Marine

HyperVent Marine

Icom

Imtra Corporation

Iridium

Italwinch

Iverson's Design, Inc.

J/Boats

JK3 Nautical Enterprises

Jeanneau America

John Deere

Johnson Marine

KKMI

Kanberra Group

Karver Systems

Kohler

Lanocote Corrosion

Protectant

Latitude 38 Publishing,

LLC

Lee Sails of California

Leisureful

Leukemia Cup Regatta

Lifeline Batteries

Live Eyewear

Please check our website at
www.strictlysailpacific.com
for updated exhibitor listings, boats
on display, and seminar information.

Seahorse Marine

The oldest American-owned yacht builder in China.

Zhyachts@MTHTrains.com
 www.SeahorseYachts.com
 www.DuckTalk.net

See at
 Strictly Sail Pacific
 in-the-water
 at Berth 17

Introducing the **Coot 36**, "tug style" steel yacht built to the same standards and scantlings as our George Buehler 36 to 78 foot Diesel Ducks. Very livable for one or two and, with all steel construction plus commercial hatches ports and doors, probably the most seaworthy 36-foot trawler yacht built.



Shown with optional Sail Assist Rig, for extra range, stability and safe harbor capabilities.

Visit SeahorseYachts.com – Builders of Diesel Ducks and other passagemakers since 1981

Marina  Vallarta
 BAY VIEW GRAND

A PRIME LOCATION MARINA LOCATED IN THE HEART OF PUERTO VALLARTA, MÉXICO.



352 VESSEL CAPACITY (UP TO 160 FEET), ELECTRICITY, WATER, PUMP OUT, 88-TON TRAVELIFT, DRY DOCK, PRIME LOCATION, RESTAURANTS, SHOPS, HOTELS, AIRPORT



+52 (322) 221-0275 | +52 (322) 221-0722

COORDINATES:
 LAT: 20° 39' N LONG: 105° 15' W

www.marina-vallarta.com.mx

OPERATED BY:

YOU ARE INVITED TO A WINE & CHEESE
OPEN HOUSE
 SAT., APRIL 30 & SUN., MAY 1 • 1-4PM



COME TO THE FRIENDLIEST CLUB ON THE BAY

We have active racing and cruising programs!

Social events every month • Friday fun nites

Other benefits:

Executive chef, weekly dinners, speaker series, live bands, wine tasting club, specialized women's club programs & more!

Oakland Yacht Club

in Alameda, CA

Call for further information

(510) 522-6868

www.oaklandyachtclub.com

*Jack London
 was a member
 from
 1913-1916*

Exhibitors by Brand

Lofrans
Lonseal
Lowrance
Lumishore
Lunasea Lighting
MRUD Emergency Rudder
MagicEzy Fibreglass Repair
Magnum Energy
Mantus Anchors
Marelube Valve Lubricant
Marina Bay Yacht Harbor
Mariners General Insurance Group
Mariners School / Mariners Learning System
Maritime Institute
Markel Insurance Company
Marlow Rope
Mastervolt Energy Systems

Mathiesen Marine
McLube
Mechanical Advantage
Mercury / Mercruiser
Mexican Association of Tourist Marinas
Midnight Solar
MidNite
Modern Sailing School & Club
Monitor Windvane
Moody Yachts
Motenergy
Muir
Mustang Survival
Musto
NKE
New England Ropes
New Found Metals
Next Generation Power
North Sails
Northern Lights

Oakland Yacht Club
Oceanic Yacht Sales
Pantaenius America Ltd.
Paralock Rules
Passage Nautical
Philippi
Pineapple Sails
Pipe Berth
PlasDeck / PlasTeak
Plastimo
Portland Plotter
Principal Financial Group
Progressive Insurance
Quantum Sails
Quickline Flat Rope Reel
RadioTeck
Rainman Desalination
Ranger Tugs
Raymarine by FLIR
Raymarine, Inc.
Real Fan Heaters

Reckmann
Recreation Publications
Renewal by Andersen
Rescue Tape / Harbor Products
Ronstan International, Inc.
Rum Reggae, Inc.
SOS Emergency Rudder
Sacramento Model Yacht Club
Sail California
Sailing Made Easy Textbook
Sailology, LLC
SailSFBay.org
SailStep, LLC
SailTime San Francisco
Samson Ropes
San Francisco Estuary Partnership
San Juan Sailing
Save Our Shores

License #0E32738

TWIN RIVERS MARINE INSURANCE AGENCY, INC.

"Your Marine Insurance Specialists"

7 Marina Plaza • Antioch, CA 94509 • At The Antioch Marina
Latitude 38° 01' 10" N - Longitude 121° 49' 10" W - Buoy 4 Red - On the San Joaquin River

- Shop Your Renewal & Save – Flexible Survey Requirements
- Broad Navigation Areas • Liveaboards • Classic Yacht Coverage
- Agreed Value Policies • Fuel Spill Liability • Get a Quote Online



Your Twin Rivers Policy Comes With an Agent



West Coast • Hawaii
Mexico • East Coast

Marine Insurance made simple, affordable and effective.

www.BoatInsuranceOnly.com (800) 259-5701

Years of unbeatable experience to match your needs to the right product.

REPRESENTING...



Commercial Marine Insurance • CALL DOUG for a QUOTE

- Marinas/Resorts
- Dealers/Brokers
- Charter/Tour/Fishing Vessels
- Boat Builders
- Marine Products Manufacturers
- Yacht Clubs
- Vessel Repair Facilities
- Rental Vessels/Workboats
- Marine Contractors
- Wholesalers & Distributors

Doug Rader Your Commercial Marine Specialist • Direct 209-334-2858

Members:



Lee Chesneau at Strictly Sail Pacific

Marine Weather Forecasting An In-depth & Closer Look (4-Workshops)

Cost: \$65 Per Paid Workshop. Prerequisites available at Strictly Sail Pacific

Instructor - Senior Meteorologist Lee Chesneau
Location: E Seminar Room at Strictly Sail Pacific

Saturday, April 9
3:00pm - 6:00pm
"Tropical Cyclone (Hurricane) Basics & the 1-2-3 Rule for Avoidance Seminar/Workshop"

Sunday, April 10
8:00am - 11:00am
"Three-Hour Surface Pressure Map Reinforcement Workshop"
Prerequisite Attend free seminar: "The Weather Briefing... Assessing Your Marine Weather Self Reliant Skills"

11:30am - 2:30pm
"Three-Hour 500 MB Reinforcement Workshop"
Prerequisite Attend free seminars: "The Weather Briefing... Assessing Your Marine Weather Self Reliant Skills" & "Unlocking the Mystery of 500 Mb Charts"

3:00pm - 6:00pm
"Three-Hour Understanding Weather and Cruise Decision Making Workshop"
Prerequisite Attend free seminars: "The Weather Briefing... Assessing Your Marine Weather Self Reliant Skills", "Unlocking the Mystery of 500 Mb Charts", & "Wind and Wave Concepts & How to Integrate the Charts with the Surface Pressure Maps"
(see boat show schedule for all)

Register at: www.strictlysailpacific.com

Saye's Rig Windvane
 Scanmar International
 Sea Beds by Michelle
 Sea Hawk Antifouling
 Paints
 Seacoast Marine Finance
 Seahorse Marine
 SeaTech Systems
 Sevcon
 Shaft Shark Line &
 Weed Cutter
 Shark
 Side-Power
 Simrad
 Solara
 Solbian
 South Beach Yacht Club
 Spade Anchor
 Sparkman & Stephens
 Spaulding Marine Center
 Spectra Watermakers
 Spinlock

Standard Horizon
 Star Marine Electronics, Inc.
 Sterling Battery Chargers
 Summer Sailstice
 Sungevity
 Suzuki Marine



Svensden's Marine
 Swedish Marine
 Swift Sailing
 TackTick Instruments
 TankTechsRx
 Tea Tree Power Gel
 and Spray
 Teakdecking Systems

Teufelberger
 The Moorings – Tonga
 and New Zealand
 Thoosa
 ThunderStruck Motors
 Torpeedo, Inc.
 Tradewinds Sailing School
 & Club
 Travelers Insurance
 Trident Funding
 Corporation
 Twin Rivers Marine
 Insurance Agency, Inc.
 US Battery
 US Sailing Association
 Ultra Marine West /
 Quickline USA
 United States Coast
 Guard Auxilliary
 Vaavud
 Variprofile Propeller
 Variprop Propeller
 VetusMaxwell, Inc.

Victron Energy
 Viking Life-Saving
 Equipment (America)
 Volvo Penta
 WAVE
 Watt & Sea Hydrogenerator
 Webasto Heating Systems
 West Coast Chartbooks
 West Coast Sailing
 West Marine
 Westerbeke
 Whitecaps Marine
 Outfitters
 Widgets
 WinchRite®
 Wind Toys
 WINSLOW® LifeRaft
 Company
 Wylie Charters
 Yachts For Sale Magazine
 Yale Cordage
 Yanmar
 Zhik

Captain's License

Maritime  Institute

**Captain's License
 Training**

*Stop by our
 booth #L14 at the
 Strictly Sail show*

Captain's License OUPV Master up to 100GT
Alameda, CA
 April 18 - 29, 2016 or July 11 - 22, 2016

<p>Radar Recertification <i>Alameda, CA</i> May 25, 2016</p>	<p>License Renewal <i>Alameda, CA</i> May 4, 2016</p>
---	--

***New Classroom Location
 in Alameda, CA***
 1150 Ballena Blvd., Suite 255

Toll Free: 888-262-8020
www.MaritimeInstitute.com

BOAT LOANS

from

 **Trident Funding**

"a fresh approach from people you can trust"

See Us At Booth B-2



**Strictly Sail
 PACIFIC**

Richmond - Marina Bay • April 7-10

Please call or stop by for a quote
JOAN BURLEIGH
(510) 749-0050 • (800) 690-7770

Loans will be arranged or made pursuant to a California Finance
 Lenders License #605 1871.

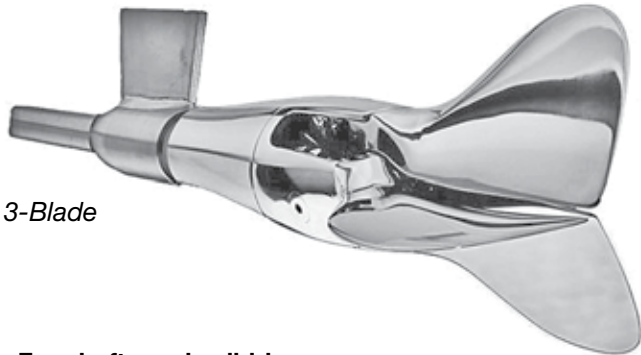
Gori propeller



3-Blade

- For shafts and saildrives
- Both 2 & 3 blade available
- Lowest drag when sailing
- The champions choice



747 Aquidneck Ave.
Middletown, RI 02842

401-847-7960

Fax: 401-849-0631

sales@ab-marine.com

www.ab-marine.com

CALL US TODAY!

800-801-8922

SHAFT SHARK

*The best rope,
line and debris
cutter there is!*



401-847-7960
sales@ab-marine.com
www.ab-marine.com



Fix & Color Fiberglass in Seconds



 www.ab-west.com

 sales@ab-west.com

Travel and

ACCOMMODATIONS

Official Hotel of
Strictly Sail Pacific 2016

Courtyard by Marriott® Oakland Emeryville

5555 Shellmound Street

Emeryville, CA 94608

(510) 652-8777

www.marriott.com



Just over the Bay Bridge from San Francisco, 10 minutes from Berkeley and just north of Oakland, the Courtyard by Marriott® Oakland Emeryville is centrally located within the Bay Area, making it the perfect home base. No matter which direction guests take for their Bay Area travels, they can start out with a hot and healthy breakfast in The Bistro – Eat. Drink. Connect®.

When they return, each of our 296 guest rooms is designed to allow for complete productivity with well-lit work areas, ergonomic chairs and free wireless Internet access. Or, they may choose to relax in our indoor pool, whirlpool or exercise room.

Contacts

AIRPORTS

Oakland International Airport (OAK) (510) 563-3300
San Francisco International Airport (SFO) (650) 761-0800

AIRPORT SHUTTLES (provided by Trip Advisor)

Air Express Cab (510) 485-4848
Airport Taxi Cab (510) 541-3331
Walnut Creek Airport Service (925) 381-9296

RICHMOND RESTAURANTS

Assemble Restaurant (510) 215-6025
Botto Bistro (510) 232-3100
Cheeseboard Pizza (510) 237-7513
Chez Panisse (510) 548-5525
Hotel Mac (510) 233-0576
Huong Tra Restaurant (510) 234-7428
Rivoli (510) 526-2542
Salute e Vita Ristorante (510) 215-0803
The Baltic (510) 237-1000

SHOW VENUE

Craneway Pavilion (510) 215-6000
Marina Bay Yacht Harbor (510) 236-1013
Richmond Convention and Visitors Bureau (510) 237-1403



More Convenient Hotels

Berkeley City Club (510) 848-7800
Claremont Club & Spa (510) 843-3000
DoubleTree by Hilton (510) 548-7920
Holiday Inn Express Berkeley (510) 548-1700
Hotel Durant (510) 845-8981
Hotel Mac (510) 233-0576
Hotel Shattuck Plaza (510) 845-7300

MARINA RIVIERA NAYARIT
AT LA CRUZ

ONE OF THE MOST UNIQUE MARINAS IN MEXICO

LARGEST MARINE TRAVELIFT ON THE MEXICAN WEST COAST WITH CAPACITY OF
150 TON. AND 32 FOOT BEAM

MORE THAN
354 VESSEL
CAPACITY FROM 30 TO 400 ft.

- FUEL STATION
- DRY DOCK
- YACHT CLUB
- SHIPYARD
- LAUNCH RAMP
- 24/7 SECURITY
- INTERNET WIFI
- HOIST
- PUMP OUT SERVICE

WiFi TV CABLE

BLUE FLAG

THE FIRST AND ONLY
BLUE FLAG MARINA IN MEXICO

LONGITUDE 105° 24' W LATITUDE 20° 45' N

MARINA RIVIERA NAYARIT

Malecon La Marina local 1A, Playas de Huanacaxtle
La Cruz de Huanacaxtle, Nayarit, MX 63732
Tel. 52 (329) 295.5526
harbormaster@marinarivieranayarit.com
MarinaRivieraNayarit.ATLaCruz

www.marinarivieranayarit.com

**RICHMOND CONVENTION
AND VISITORS BUREAU**

welcomes you!



PACIFIC

Marina Bay & Craneway Pavilion

Visit our historic neighborhoods and destinations, museums, attractions, specialty dining and more!



**See us at
BOOTH J-14
VISIT RICHMOND
information table**

www.visitrichmondca.com

BOAT LOANS

Rates as low as 3.28%*

Unbeatable rates.

Call Sally Kraft today
for a free quote.

(925) 963-2926



*\$350k loan amount. Monthly variable.
Rates subject to change. Call for complete details.



www.seacoastmarine.net

A division of Seacoast National Bank.

Parking and

PUBLIC TRANSIT

AC Transit (Alameda and Contra Costa Counties bus service connecting the East Bay and SF) 511

Airport Transportation 511

Amtrak Passenger Trains (800) 872-7245

Amtrak offers a 10% discount off the best available rail fare to Richmond, CA between April 4-11, 2016.

To book your reservation, call Amtrak at (800) 872-7245 or contact your local travel agent.



The Boat Show cannot be booked via Internet. Please be sure to refer to Convention Fare Code X91Y-935 when making your reservation. This offer is

not valid on the Auto Train and Acela Service. Fare is valid on Amtrak Regional for all departures seven days a week, except for holiday blackouts.

Offer valid with Sleepers, Business Class or First Class seats with payment of the full applicable accommodation charges.

BART (Bay Area Rapid Transit connecting San Francisco, Daly City, SFO and 25 East Bay cities)

(650) 992-2278 or (510) 465-2278

Golden Gate Transit (415) 455-2000

Greyhound Bus (800) 231-2222

Muni (SF Bus and Cable Car) 511 or (415) 673-6864

Regional Transportation Information 511

Uber – FREE Rides!

Request a ride with the tap of a button!

Take Uber to or from the Strictly Sail Pacific Boat Show this week. Uber is offering new users a free first ride (up to \$25). Just enter promo code SSPAC16 when you sign up in the app, or text SSPAC16 to 827-222.



You can also sign up at:

<http://www.uber.com/go/SSPAC16>

and download the app for Android, Blackberry, or iPhone. Then sit back and enjoy the magic of Uber, everyone's private driver.

(Valid for new users only, TAXI excluded.)

To view a show floor plan,
please go to

www.strictlysailpacific.com

Directions

CRANEWAY PAVILION
1414 Harbour Way,
South Marina District, Richmond CA 94804

PARKING

Craneway Pavilion has 1200 private and secure parking spots.

Note: Craneway Pavilion is respectful of its neighbors and as a guest of the Craneway we extend this obligation to you as well. Please do not park in nearby business parks, neighborhoods or residential parking lots in the area. All vehicles parked in unauthorized areas will be towed at owner's expense.

NEAREST MAJOR AIRPORTS

Oakland/OAK 22.5 miles, 20-30 minutes per traffic; and San Francisco/SFO 27 miles, 30-60 minutes per traffic.

BY WATER

Contact Marina Bay Yacht Harbor at (510) 236-1013.

DRIVING

FROM OAKLAND, ALAMEDA, SAN JOSE:

Take 880 Northbound to 580 Westbound. Continue on 580 West towards Pt. Richmond. Exit Harbour Way South (Cutting Blvd.), make immediate right onto Cutting Blvd. (at the light). Make an immediate right onto Harbour Way South (at the light) and follow it to the waterfront.

FROM SAN FRANCISCO, BERKELEY:

Take 80 Eastbound to 580 Westbound. Continue on 580 West towards Pt. Richmond. Exit Harbour Way South (Cutting Blvd.), make immediate right onto Cutting Blvd. (at the light). Make an immediate right onto Harbour Way South (at the light) and follow it to the waterfront.

FROM WALNUT CREEK:

Take 24 Westbound. Continue on 580 Westbound towards Pt. Richmond. Exit Harbour Way South (Cutting Blvd.), make immediate right onto Cutting Blvd. (at the light). Make an immediate right onto Harbour Way South (at the light) and follow it to the waterfront.

FROM MARIN:

Take the San Rafael Bridge/580 Eastbound. Exit Cutting Blvd. Turn left onto Cutting Blvd. Make a right onto Harbour Way South and follow it to the waterfront.

FROM SACRAMENTO:

Take 80 Westbound. Exit Cutting Blvd. Turn right onto Cutting Blvd. Turn left onto Harbour Way South and follow it to the waterfront.

Cutting Edge

NEW Offshore Knife

- Lightweight
- One Hand Opening
- Straight or Serrated Locking Blade
- Superior Blade Sharpness And Durability



Wichard
WORLD'S HIGHEST QUALITY YACHT HARDWARE

wichardamerica.com/ | tel: (401) 683-5055
sales@wichard-sparcraft.com

See Will, Sarah, John & Karen!

FEEL THE FREEDOM

With an Independent Self-Steering Windvane AND 'Ready to go' Emergency Rudder

- Your best crew member - doesn't eat, sleep, or talk back!
- No problem to install OFF CENTER - keep your davits or swim step
- No lines in the cockpit connecting to your wheel or tiller
- Have confidence in case of main steering or rudder failure



Also Exhibiting:

www.hydrovane.com



STEERING THE DREAM



ADVANCED MAINSAIL MANAGEMENT

In-Boom Furling Engineered For Your Boat

- Eight Different Sizes & Models
- Multi-Factor Design Program Assures Fit
- Better Sail Shape Than In-Mast Furlers
- Elegant Tapered Styling in Carbon or Aluminum



MORRIS 42X
PHOTO BY BILLY BLACK

See Us At Strictly Sail Pacific Booth K5

LEISURE FURL™

The Worldwide Leader for In-Boom Reefing Systems

www.forespar.com | 949.858.8820



The 10+ Year Anti-Fouling Paint

How long does your anti-fouling work?



13 years before this Reliance 44 needed the first touch up!

Coppercoat

The copper anti-fouling that works
AND is legal in California!

www.coppercoatusa.com
info@coppercoatusa.com
321-514-9197

MARINA CORTEZ
LA PAZ

Mexico's Premier Marina

50 slips, accommodating even the largest vessels.
Electricity at each slip and Wireless Internet Access.
The most modern Marina Design in Mexico.

www.MarinaCortez.com

Email: dockmaster@marinacortez.com • Office: +52+612 123 4101
Fax: +52 612 125 4212 • From the USA: +52+1+612 157 0013

ADVERTISERS' INDEX

The Strictly Sail Pacific Boat Show Guide is brought to you by the following advertisers. Please support the businesses that made this publication possible.

AB Marine.....	34	Marina El Cid	21
Afterguard Sailing Academy	21	Marina Riviera Nayarit.....	35
Bainbridge	26	Marina Vallarta.....	31
Bay Marine Boat Works.....	13	Maritime Institute.....	33
Beneteau USA.....	9	Mathiesen Marine.....	19
Chesneau, Lee, Marine Weather Forecasting.....	32	New England Ropes.....	21
Club Nautique	27	Oakland Yacht Club	31
Coppercoat USA.....	38	Pantaenius Yacht Insurance.....	29
Doyle Sails.....	15	Pettit Paint	2-3
Euro Marine Trading.....	39	R&B Cellars	23
Forespar	38	Richmond Convention & Visitors Bureau.....	36
Hanse / Moody.....	11	Sail California	7
Hobie Cat.....	40	San Juan Sailing.....	29
Hydrovane	38	Seacoast Marine Finance.....	36
Jeanneau America.....	5	Seahorse Marine.....	31
LaPaz Hotel.....	29	Svensden's Boat Works.....	25
Lifeline Batteries.....	26	Trident Funding.....	33
Marina Bay Yacht Harbor.....	20	Twin Rivers Marine Insurance	32
Marina Cortez	39	Wichard Sparcraft, Inc.	37
Marina Costa Baja.....	17		

antal

Deck Hardware for Sailboats

Antal Winches



XT self-tailing models are available in aluminum, chrome-plated bronze and natural polished bronze. Available in racing, cruising, electric and hydraulic and come in one-, two- and three-speed options. A full range of winch handles are also available.

Antal Clutches



Antal's patented V-Cam is designed to reduce line compression without sacrificing holding capacity and features an ergonomic silver anodized aluminum handle. Available in single, double, triple and quadruple models for 8-10mm, 10-12mm or 12-14mm line. Full range of organizers also available.

EURO MARINE
Trading, Inc.

62 Halsey Street • Newport, RI 02840
Tel. 401-849-0060 or 800-222-7712

www.euromarinetrading.com

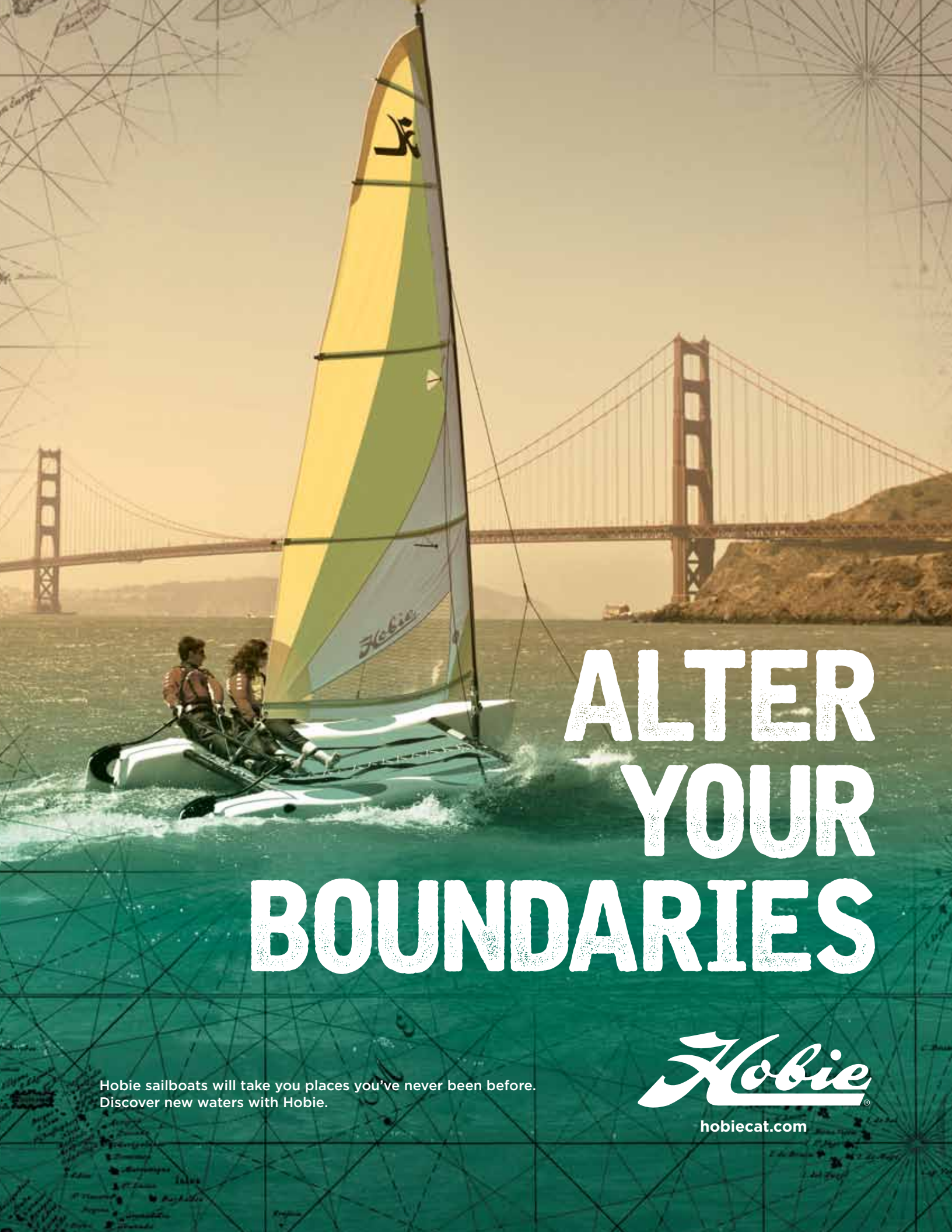

ALTER YOUR BOUNDARIES

Hobie sailboats will take you places you've never been before.
Discover new waters with Hobie.

Hobie[®]

hobiecat.com